

Lined Reducer

Concentric Reducer

Eccentric Reducer

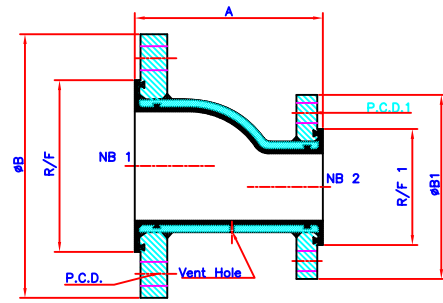
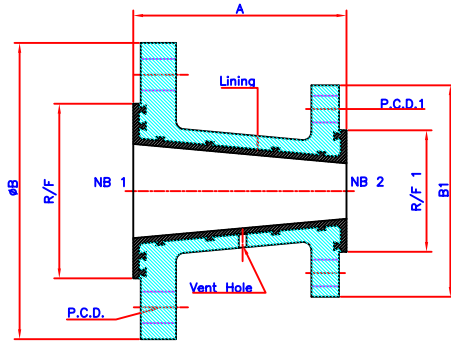

ASME B 16.5 - 150#

Size		NB1			NB2			NB1	NB2	Face to Face
(NB-1)	(NB-2)	Flange OD øB	Raised Face Diameter (R/F)	Flange P.C.D.	Flange OD øB1	Raised Face Diameter (R/F1)	Flange P.C.D.1	Lining Thickness	Lining Thickness	A
25	20	108.0	51	79.4	98.4	43	69.8	3.0	3.0	114
40	25	127.0	73	98.4	108.0	51	79.4	3.0	3.0	114
50	25	152.4	92	120.6	108.0	51	79.4	3.5	3.0	127
50	40	152.4	92	120.6	127.0	73	98.4	3.5	3.0	127
65	25	177.8	105	139.7	108.0	51	79.4	3.5	3.0	127
65	40	177.8	105	139.7	127.0	73	98.4	3.5	3.0	127
65	50	177.8	105	139.7	152.4	92	120.6	3.5	3.5	127
80	25	190.5	127	152.4	108.0	51	79.4	3.5	3.0	152
80	40	190.5	127	152.4	127.0	73	98.4	3.5	3.0	152
80	50	190.5	127	152.4	152.4	92	120.6	3.5	3.5	152
80	65	190.5	127	152.4	177.8	105	139.7	3.5	3.5	152
100	25	228.6	157	190.5	108.0	51	79.4	4.5	3.0	178
100	40	228.6	157	190.5	127.0	73	98.4	4.5	3.0	178
100	50	228.6	157	190.5	152.4	92	120.6	4.5	3.5	178
100	65	228.6	157	190.5	177.8	105	139.7	4.5	3.5	178
100	80	228.6	157	190.5	190.5	127	152.4	4.5	3.5	178
150	25	279.4	216	241.3	108.0	51	79.4	5.0	3.0	229
150	40	279.4	216	241.3	127.0	73	98.4	5.0	3.0	229
150	50	279.4	216	241.3	152.4	92	120.6	5.0	3.5	229
150	65	279.4	216	241.3	177.8	105	139.7	5.0	3.5	229
150	80	279.4	216	241.3	190.5	127	152.4	5.0	3.5	229
150	100	279.4	216	241.3	228.6	157	190.5	5.0	4.5	229
200	25	342.9	270	298.4	108.0	51	79.4	5.5	3.0	279
200	40	342.9	270	298.4	127.0	73	98.4	5.5	3.0	279
200	50	342.9	270	298.4	152.4	92	120.6	5.5	3.5	279
200	65	342.9	270	298.4	177.8	105	139.7	5.5	3.5	279
200	80	342.9	270	298.4	190.5	127	152.4	5.5	3.5	279
200	100	342.9	270	298.4	228.6	157	190.5	5.5	4.5	279
200	150	342.9	270	298.4	279.4	216	241.3	5.5	5.0	279
250	40	406.4	324	361.9	127.0	73	98.4	6.5	3.0	305
250	50	406.4	324	361.9	152.4	92	120.6	6.5	3.5	305
250	65	406.4	324	361.9	177.8	105	139.7	6.5	3.5	305
250	80	406.4	324	361.9	190.5	127	152.4	6.5	3.5	305
250	100	406.4	324	361.9	228.6	157	190.5	6.5	4.5	305
250	150	406.4	324	361.9	279.4	216	241.3	6.5	5.0	305
250	200	406.4	324	361.9	342.9	270	298.4	6.5	5.5	305
300	50	482.6	381	431.8	152.4	92	120.6	8.0	3.5	356
300	80	482.6	381	431.8	190.5	127	152.4	8.0	3.5	356
300	100	482.6	381	431.8	228.6	157	190.5	8.0	4.5	356
300	150	482.6	381	431.8	279.4	216	241.3	8.0	5.0	356
300	200	482.6	381	431.8	342.9	270	298.4	8.0	5.5	356
350	50	533.4	413	476.2	152.4	92	120.6	8.0	3.5	406
350	80	533.4	413	476.2	190.5	127	152.4	8.0	3.5	406
350	100	533.4	413	476.2	228.6	157	190.5	8.0	4.5	406
350	150	533.4	413	476.2	279.4	216	241.3	8.0	5.0	406
350	200	533.4	413	476.2	342.9	270	298.4	8.0	5.5	406
350	300	533.4	413	476.2	482.6	381	431.8	8.0	6.5	406

ALL DIMENSION ARE IN mm

Casting Tee Material Data

CASTING : ASTM A 395 / A 216 WCB /SS 304/ SS 316

Lining : PFA / FEP / PP

Fabrication Tee Material Data

Flange : IS : 2062 / A 105 / SS 304 / SS 316

Pipe : ASTM A 106 Gr B / SS 304 / SS 316

PIPE SCH- 40 / SCH -80

Lining : PFA / FEP / PP

Flange Std.

1) ASME B 16.5-150# & 300#

2) DIN.STD.-PN6 / PN10 / PN 16 / PN 25

3) BS STD.-TABLE -D/E/F/H

4) JIS 5K / JIS 10K

Note : In Casting Con.Reducer Flange Std.Applicable ASME B 16.5 -150#

LINED REDUCING FLANGE

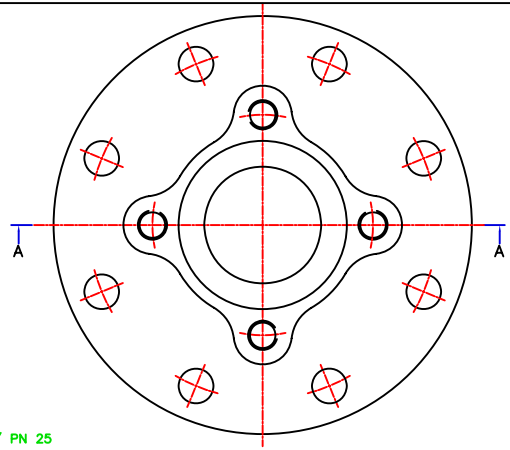

Casting Tee Material Data

CASTING : ASTM A 395 / A 216 WCB / SS 304/ SS 316
 Lining : PFA / FEP / PP

Fabrication Tee Material Data

Flange : IS : 2062 / A 105 / SS 304 / SS 316
 Pipe : ASTM A 106 Gr B / SS 304 / SS 316
 PIPE SCH- 40 / SCH -80
 Lining : PFA / FEP / PP

Flange Std.

- 1) ASME B 16.5-150# & 300#
- 2) DIN.STD.-PN6 / PN10 / PN 16 / PN 25
- 3) BS STD.-TABLE -D/E/F/H
- 4) JIS 5K / JIS 10K

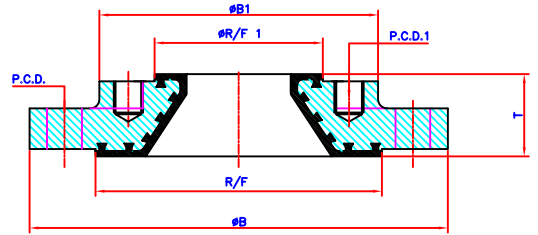

SECTION-AA

ASME B 16.5 - 150#

Size		NB1			NB2			NB1	NB2	Face to Face
(NB-1)	(NB-2)	Flange OD #B	Raised Face Diameter (R/F)	Flange P.C.D.	Flange OD #B1	Raised Face Diameter (R/F1)	Flange P.C.D.1	Lining Thickness	Lining Thickness	T
25	20	108.0	51	79.4	98.4	43	69.8	3.0	3.0	35
40	25	127.0	73	98.4	108.0	51	79.4	3.0	3.0	35
50	25	152.4	92	120.6	108.0	51	79.4	3.5	3.0	35
50	40	152.4	92	120.6	127.0	73	98.4	3.5	3.0	35
65	25	177.8	105	139.7	108.0	51	79.4	3.5	3.0	35
65	40	177.8	105	139.7	127.0	73	98.4	3.5	3.0	35
65	50	177.8	105	139.7	152.4	92	120.6	3.5	3.5	35
80	25	190.5	127	152.4	108.0	51	79.4	3.5	3.0	45
80	40	190.5	127	152.4	127.0	73	98.4	3.5	3.0	45
80	50	190.5	127	152.4	152.4	92	120.6	3.5	3.5	45
80	65	190.5	127	152.4	177.8	105	139.7	3.5	3.5	45
100	25	228.6	157	190.5	108.0	51	79.4	4.5	3.0	45
100	40	228.6	157	190.5	127.0	73	98.4	4.5	3.0	45
100	50	228.6	157	190.5	152.4	92	120.6	4.5	3.5	45
100	65	228.6	157	190.5	177.8	105	139.7	4.5	3.5	45
100	80	228.6	157	190.5	190.5	127	152.4	4.5	3.5	45
125	25	254.0	185	215.9	108.0	51	79.4	4.5	3.0	45
125	40	254.0	185	215.9	127.0	73	98.4	4.5	3.0	45
125	50	254.0	185	215.9	152.4	92	120.6	4.5	3.5	45
125	65	254.0	185	215.9	177.8	105	139.7	4.5	3.5	45
125	80	254.0	185	215.9	190.5	127	152.4	4.5	3.5	45
125	100	254.0	185	215.9	228.6	157	190.5	4.5	4.5	45
150	25	279.4	216	241.3	108.0	51	79.4	5.0	3.0	54
150	40	279.4	216	241.3	127.0	73	98.4	5.0	3.0	54
150	50	279.4	216	241.3	152.4	92	120.6	5.0	3.5	54
150	65	279.4	216	241.3	177.8	105	139.7	5.0	3.5	54
150	80	279.4	216	241.3	190.5	127	152.4	5.0	3.5	54
150	100	279.4	216	241.3	228.6	157	190.5	5.0	4.5	54
200	25	342.9	270	298.4	108.0	51	79.4	5.5	3.0	54
200	40	342.9	270	298.4	127.0	73	98.4	5.5	3.0	54
200	50	342.9	270	298.4	152.4	92	120.6	5.5	3.5	54
200	65	342.9	270	298.4	177.8	105	139.7	5.5	3.5	54
200	80	342.9	270	298.4	190.5	127	152.4	5.5	3.5	54
200	100	342.9	270	298.4	228.6	157	190.5	5.5	4.5	54
200	150	342.9	270	298.4	279.4	216	241.3	5.5	5.0	54
250	40	406.4	324	361.9	127.0	73	98.4	6.5	3.0	54
250	50	406.4	324	361.9	152.4	92	120.6	6.5	3.5	54
250	65	406.4	324	361.9	177.8	105	139.7	6.5	3.5	54
250	80	406.4	324	361.9	190.5	127	152.4	6.5	3.5	54
250	100	406.4	324	361.9	228.6	157	190.5	6.5	4.5	54
250	150	406.4	324	361.9	279.4	216	241.3	6.5	5.0	54
250	200	406.4	324	361.9	342.9	270	298.4	6.5	5.5	54
300	50	482.6	381	431.8	152.4	92	120.6	8.0	3.5	54
300	80	482.6	381	431.8	190.5	127	152.4	8.0	3.5	54
300	100	482.6	381	431.8	228.6	157	190.5	8.0	4.5	54
300	150	482.6	381	431.8	279.4	216	241.3	8.0	5.0	54
300	200	482.6	381	431.8	342.9	270	298.4	8.0	5.5	54
350	50	533.4	413	476.2	152.4	92	120.6	8.0	3.5	54
350	80	533.4	413	476.2	190.5	127	152.4	8.0	3.5	54
350	100	533.4	413	476.2	228.6	157	190.5	8.0	4.5	54
350	150	533.4	413	476.2	279.4	216	241.3	8.0	5.0	54
350	200	533.4	413	476.2	342.9	270	298.4	8.0	5.5	54
350	300	533.4	413	476.2	482.6	381	431.8	8.0	6.5	54

ALL DIMENSION ARE IN mm